

MUNICIPALITY OF ANCHORAGE

DEPARTMENT OF PUBLIC WORKS

CONSTRUCTION DIVISION

SOILS LOG

HOLE NO. 1 19

LOCATION 26TH/27TH Ave. R.I.D. / E of W. 27TH Ave.
270' West of the E of Arctic Blvd.

DATE 11/8/79

BY D.N. Bolles

COMMENTS _____

DEPTH 9'

WATER TABLE NONE

	DEPTH	UNIFIED CLASS	FROST GROUP	DESCRIPTION
EX-717 1-A	0	SW/SM	F-2	Existing road surface Brown - Gravelly (43%) Sand (45%) w/silt (12%) / Moist. 4%
EX-718 1-B	1	SM	F-3	NP/ Med. density. Red - Silty (31%) sand (59%) w/gravel (10%) / Moist. 14%
	2			NP/ Med. density.
EX-719 1-C	3	SP	NFS	Gray - Brown, varved / Sand (97%) / Moist. 4%
	4			Silt 2% / Gravel 1% / NP/ Med. low density.
EX-720 1-D	5	SP	NFS	Gray - Gravelly (18%) Sand (80%) / Moist. 3% / silt 2%
	6			NP/ Med. density.
EX-721 1-E	7	SP	NFS	Gray - Sand (91%) w/gravel (8%) / Moist. 3% / silt 1%
	8			NP/ Medium density.
EX-722 1-F	9	SP/SM	NFS	Gray - Brown - Varved - Sand (93%) w/silt (5%) / Moist. 4%
	10			Gravel (2%) / NP/ Med. density.
	11			
	12			
	13			
	14			

LOCATION SKETCH:

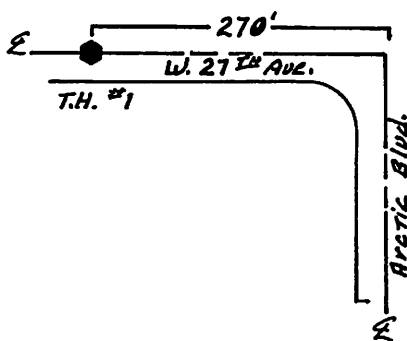

LEGEND

SYMBOL



TEST HOLE



WATER TABLE

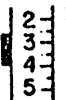

FROZEN MATERIAL

ALL FROST CLASSIFICATION
 BASED ON THE .02mm = 50%
 OF THE #200 UNLESS
 OTHERWISE NOTED

GRID NO. 1529

MUNICIPALITY OF ANCHORAGE
 DEPARTMENT OF PUBLIC WORKS
 CONSTRUCTION DIVISION

FILE COPY

PROJECT 26th & 27th Ave. RID Test Holes
 CONTRACTOR _____

TEST NO. EX-717
 DATE Nov. 8, 1979

MATERIAL SOURCE 1-A / 0 to 0.5' below O.G.

LOCATION SAMPLED 27th Ave. / 270' W & Arctic Blvd. BY M. Krueger / D. Balles

COMMENTS SW-SM/F-2 / Gravelly sand w/ silt / 4% Moisture
43% 45% 12%

REPORTED TO _____

PLOTTED BY BD CHECKED BY _____ MATERIALS SUPERVISOR P. O. Pennington

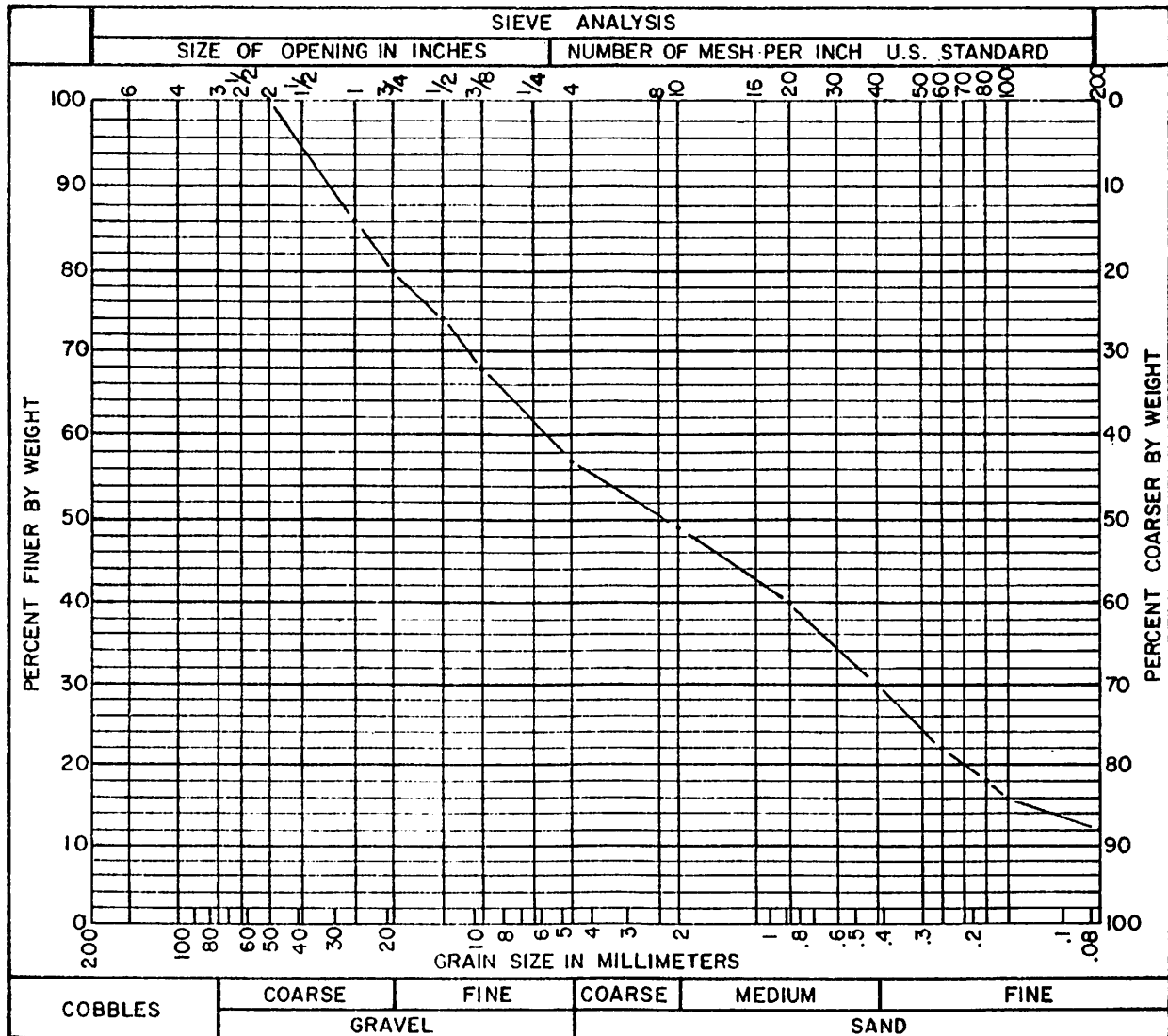

INSPECTOR'S COMMENTS _____

MUNICIPALITY OF ANCHORAGE
 DEPARTMENT OF PUBLIC WORKS
 CONSTRUCTION DIVISION

FILE COPY

TEST NO. EX-718

DATE Nov. 8, 1979

PROJECT 26th & 27th Ave. RID Test Holes

CONTRACTOR _____

MATERIAL SOURCE 1-B / 0⁵' to 1⁵' below O.G.

LOCATION SAMPLED 27th Ave. / 270' W of Arctic Blvd. BY M. Krueger

COMMENTS SM/F-3 / Silty Sand w/ Gravel / 14% Moisture
31% 59% 10%

REPORTED TO _____

PLOTTED BY BD CHECKED BY _____ MATERIALS SUPERVISOR T.O. Pennington

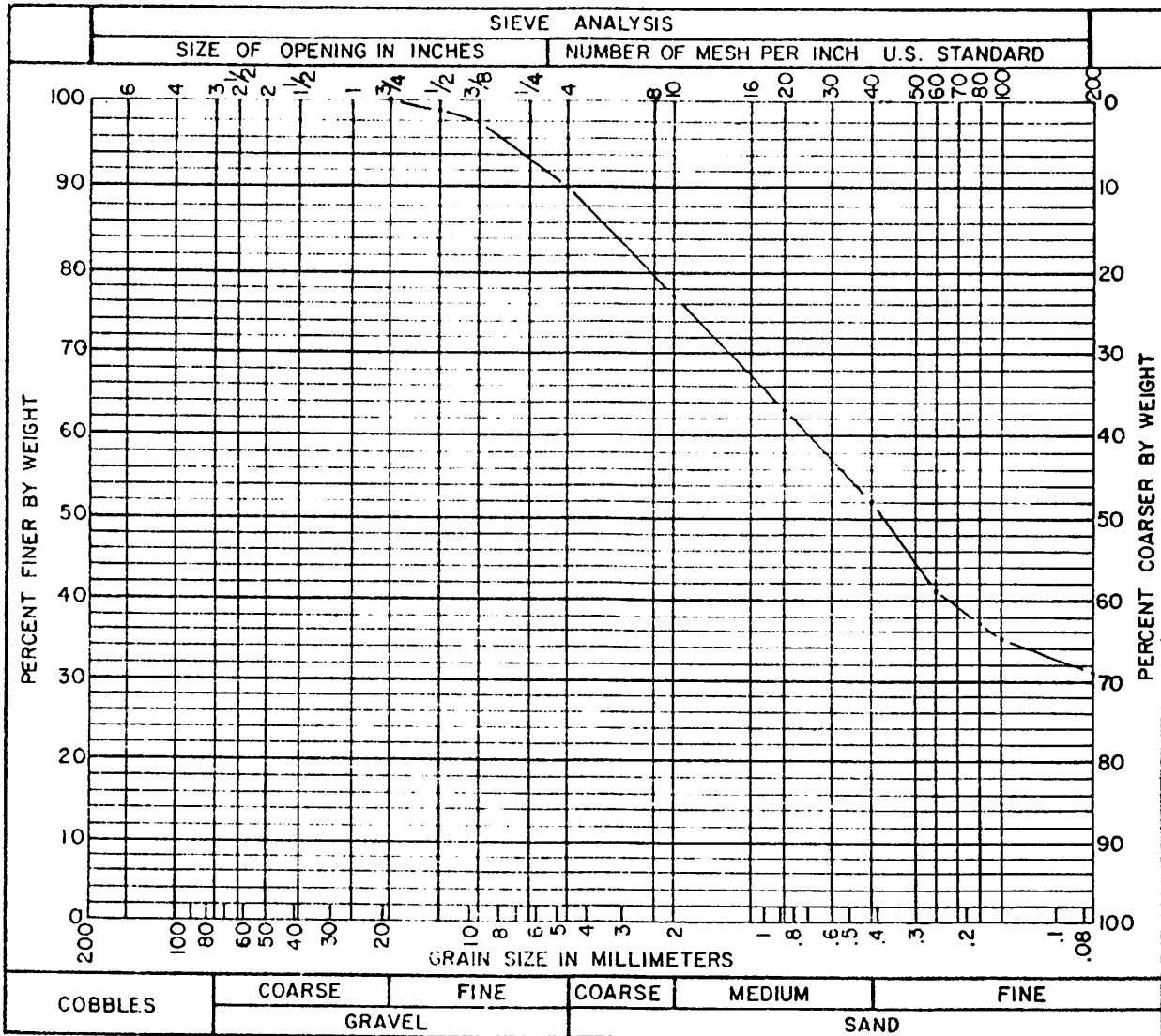

INSPECTOR'S COMMENTS _____

MUNICIPALITY OF ANCHORAGE
 DEPARTMENT OF PUBLIC WORKS
 CONSTRUCTION DIVISION

FILE COPY

PROJECT 26th Ave & 27th Ave RID Test Holes
 CONTRACTOR _____

TEST NO. EX-719
 DATE Nov. 8, 1979

MATERIAL SOURCE 1-C / 15' to 45' below O.G.

LOCATION SAMPLED E 27th Ave / 270' W of Arctic Blvd. BY M. Kueger, D. Bolles

COMMENTS SP/NES / SAND / 97% / 4% Moisture / 2% Silt; 1% Gravel

REPORTED TO _____

PLOTTED BY SA CHECKED BY BD MATERIALS SUPERVISOR P.O. Pennington

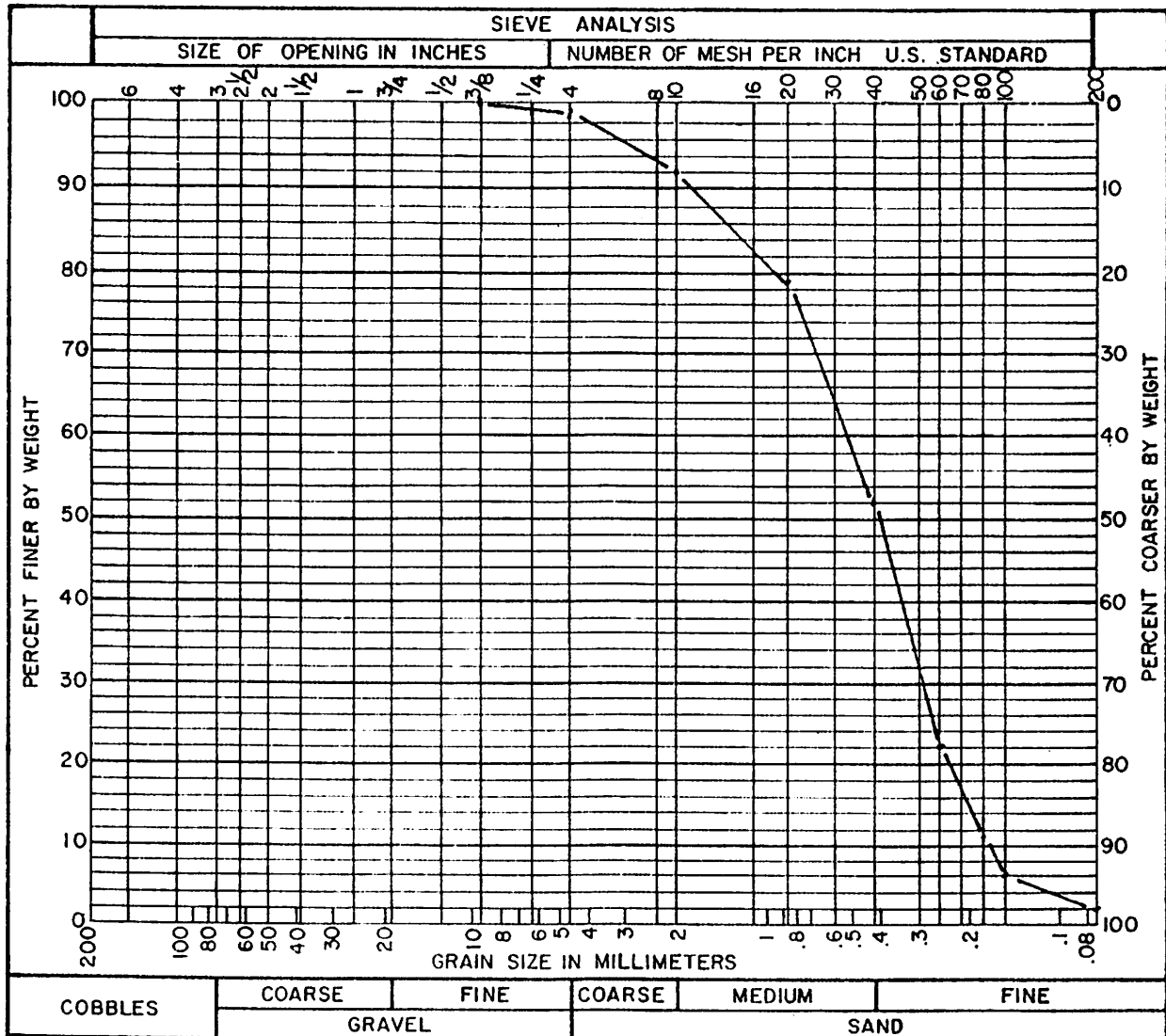

INSPECTOR'S COMMENTS _____

MUNICIPALITY OF ANCHORAGE
 DEPARTMENT OF PUBLIC WORKS
 CONSTRUCTION DIVISION

FILE COPY

PROJECT 26th & 27th Ave RID

Test Holes

TEST NO. EX-720

DATE Nov. 8, 1979

CONTRACTOR _____

MATERIAL SOURCE 1-D/4^{5'} to 6^{5'} below O.G.

LOCATION SAMPLED E-27th Ave / 270th Wt Arctic Blvd.

BY M. Krueger & D. Ballas

COMMENTS SP/NFS / Gravel Sand / 18% Moisture / 80% Silt / 2%

REPORTED TO _____

PLOTTED BY sd CHECKED BY AD MATERIALS SUPERVISOR J. O. Pennington

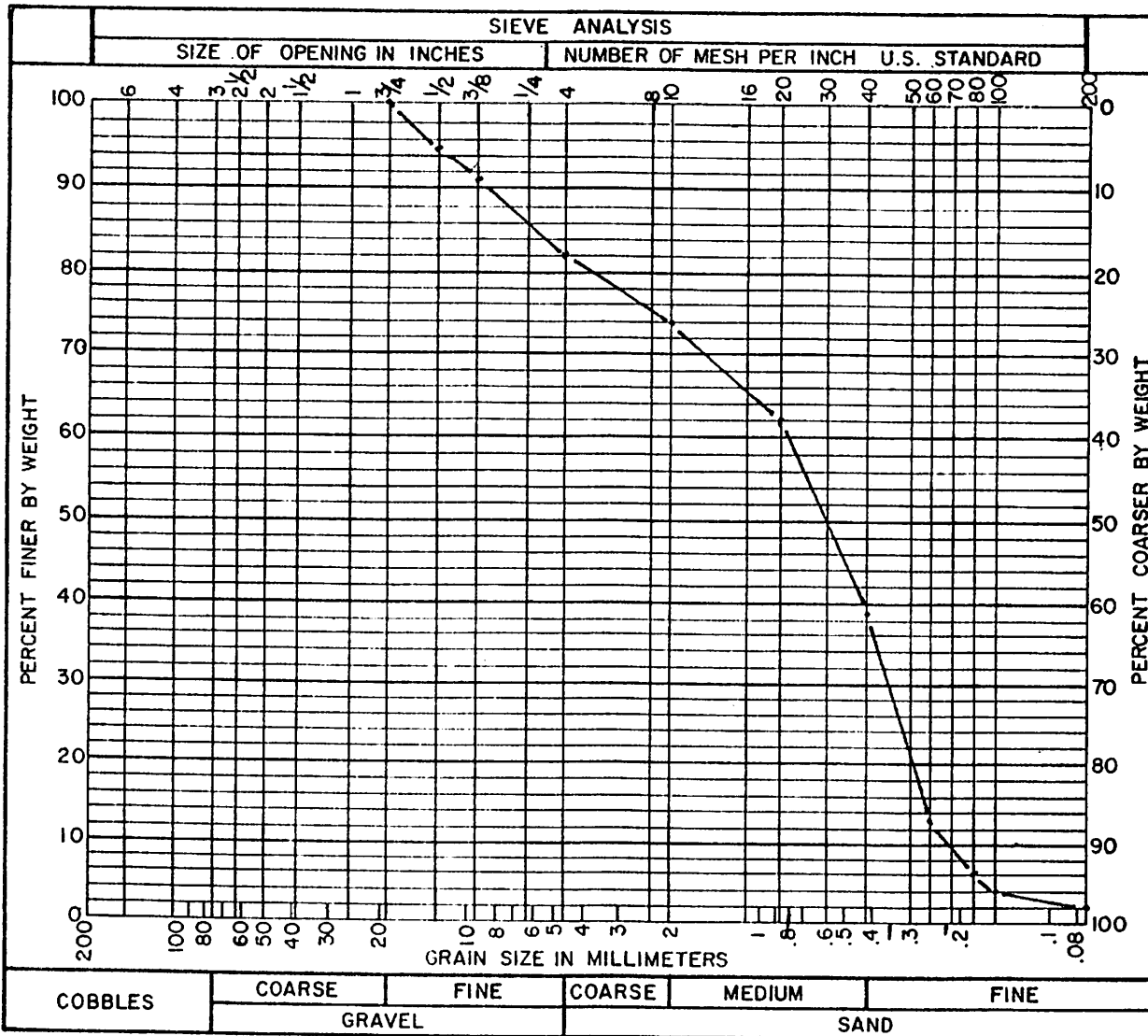

INSPECTOR'S COMMENTS _____

MUNICIPALITY OF ANCHORAGE
 DEPARTMENT OF PUBLIC WORKS
 CONSTRUCTION DIVISION

FILE COPY

PROJECT 26th & 27th Ave RID Test Holes TEST NO. EX-721
 DATE Nov. 8, 1979
 CONTRACTOR _____
 MATERIAL SOURCE 1-E/6⁵' to 8²' below O.G.
 LOCATION SAMPLED 27th Ave. / 270' W of Arctic Blvd. BY M. Krueger, D. Bolles
 COMMENTS SP/NFS / Sand w/ Gravel / 3% Moisture / 1% Silt
 REPORTED TO _____
 PLOTTED BY SA CHECKED BY BD MATERIALS SUPERVISOR J. D. Pennington

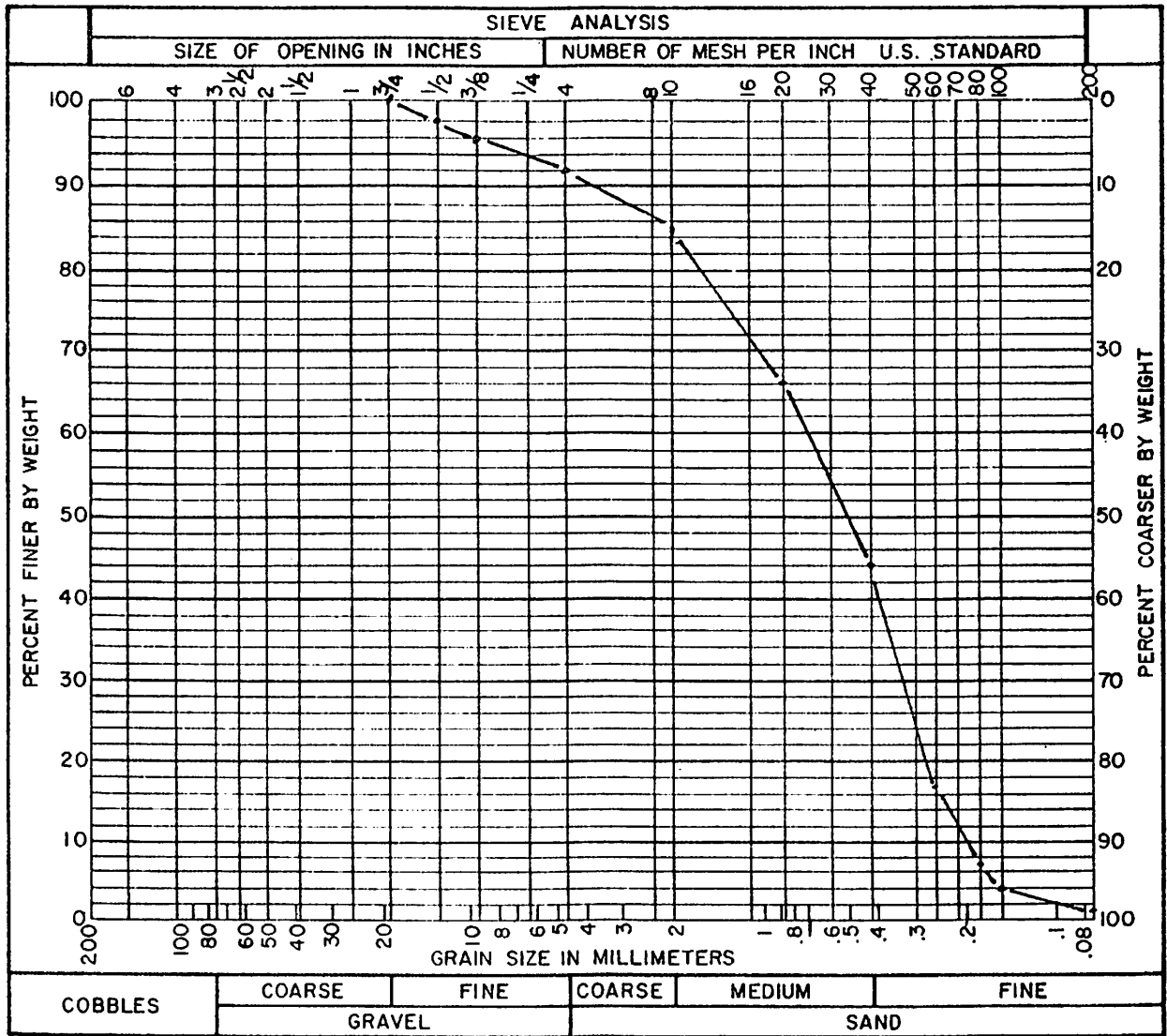

INSPECTOR'S COMMENTS _____

MUNICIPALITY OF ANCHORAGE
 DEPARTMENT OF PUBLIC WORKS
 CONSTRUCTION DIVISION

FILE COPY

TEST NO. EX-722

DATE NOV. 8, 1979

PROJECT 26th & 27th Ave RID Test Holes

CONTRACTOR _____

MATERIAL SOURCE 1-F/8' to 9' below O.G.

LOCATION SAMPLED 227th Ave / 220' W of Arctic Blvd BY M. Krueger, D. Bolles

COMMENTS SP-SM/NFS / Sand w/ Silt / 4% Moisture / 2% Gravel
93% 5%

REPORTED TO _____

PLOTTED BY BD CHECKED BY _____ MATERIALS SUPERVISOR J. D. Pennington

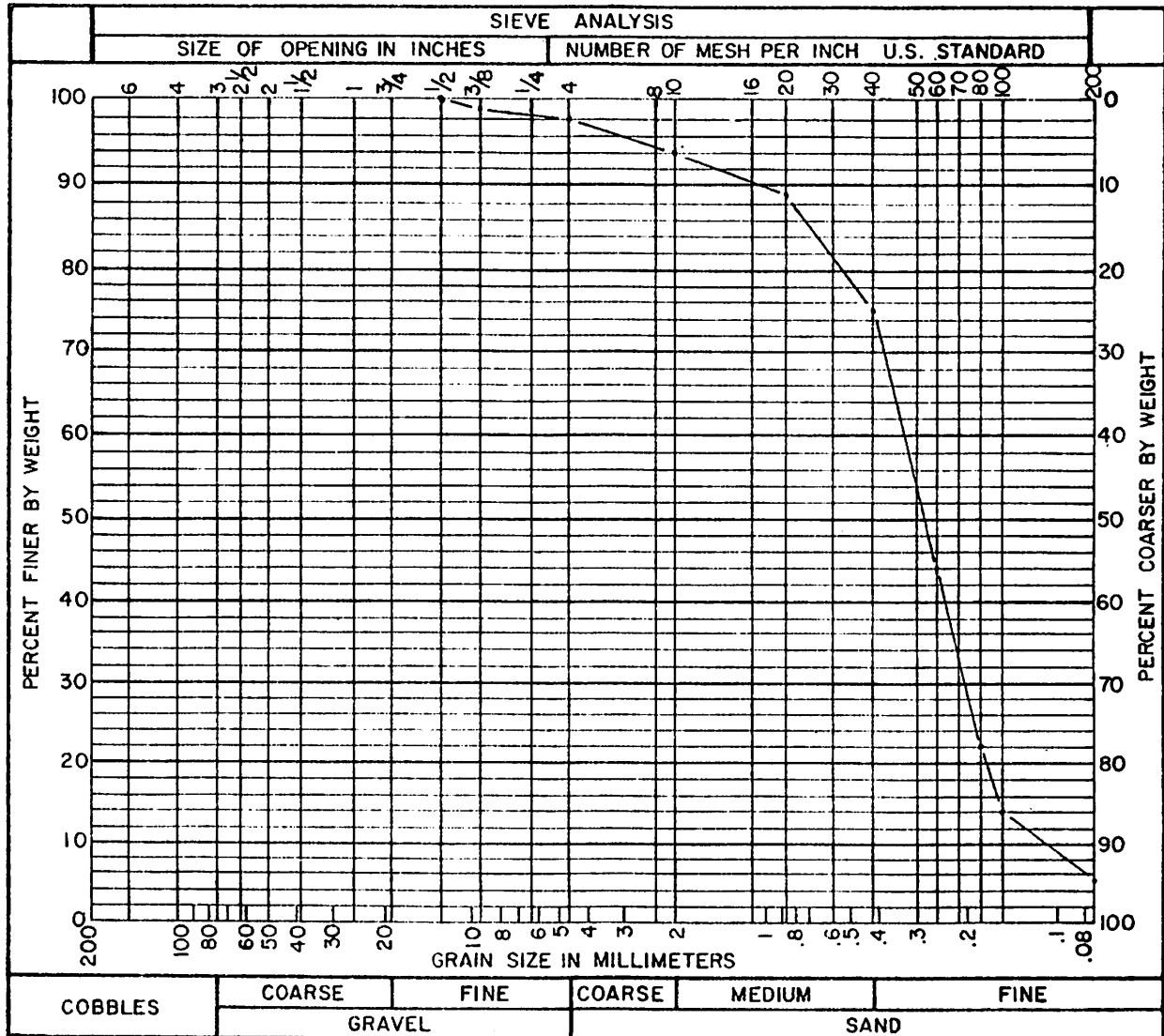

INSPECTOR'S COMMENTS _____